

Chapter 7 Appendix 2a

EXAMPLE OF SHIELDING FILE

The shielding histories do not all contain the same information. The data available in the shielding histories varies according to the date when the original interview was conducted, the location of the survivor (Hiroshima or Nagasaki), and the particular situation or configuration existing for the survivor ATB. All shielding histories examined have the "Radiation Shielding Summary" form which contains the information required for the T57D system. The house penetration distance was used to calculate the attenuation factor for survivors in Japanese houses in the T57D system.

Atomic Bomb Casualty Commission 原爆被害調査委員会									
RADIATION SHIELDING SUMMARY 放射線遮蔽総括									
Block No. 地区番号 238	RSS	Family Name 姓 (Hans) 姓		Given Name 名	Sex 性別	DATE 調査年月日 Day 日 Mo. 月 Year 年 07 07 67	Corp. Age 歳 67	Master File Number 基本記録番号 291-999	
OTHER PATIENTS AT THE SAME LOCATION AND THEIR PRESENT STATUS 同じ地点で被爆した他の患者									
No. 番号	M.F. Number 基本記録番号	Name 氏名	Sex 性別	ATB 原爆被害者	Death Date 死亡年月日	Present Address or Cause of Death 現住所又は死因			RSS
1									
2									
3									
4									
5									
6									
REMARKS 備考									
Distance from Hypocenter (Meters) 爆心からの距離 (米) 1,355 m M.F.D. 1,292 m									
House Penetration Distance (Feet) 家屋透過距離 (尺) 221 6.72 m.									
	GAMMA (r.) γ線				NEUTRON (exp) 中性子				
Air Dose 空中	164.				54.0				
Attenuation Factor 減衰因子	0.62				0.41				
T57 Dose 線量	102.				22.1				
Dose 線量									
Interviewed by: 調査員氏名:			Source of Information: 出 所:			Reliability 信頼性			
RADIATION SHIELDING SUMMARY 放射線遮蔽総括									
ABCC Form No. RAD-11 (Sep 58)									

U. S. S. - 1

NAME:
M.F. NO.: 291-999
DATE OF BIRTH: 18 December 1895
L.T.B.: 500 Nishi Temma-cho
P.O.: None
O.T.B.: Agricultural implements manufacturer (self managed)
CLOTHING: White cotton shirt and long cotton khaki trousers.
FLASH: A pale fire-ball like an electric spark was thought to be seen before his eyes.
HEAT: None.
BLAST: His house collapsed toward the west, perhaps because the blast blew from the south to the west and he was pinned under it.
SOUND: None.
RAIN: About the time (0900 hours) he escaped to the Temma River, large drops of rain kept on falling for about an hour and a half and he was drenched to the skin.

On that morning, he was lying on his back in an eight-mat room. His wife, (M.F. No. 292-000), was stretching a mosquito net in the same room and his eldest daughter, (M.F. No. 292-001), was combing her hair in a three-mat room. Just at that moment, he was exposed to the A-bombing. In a moment, when he was exposed, a pale fire-ball (about 2 feet in diameter) like an electric spark was dropped before his eyes and simultaneously, the house was lifted from the ground as though being thrown up in the sky, perhaps because the blast blew in from the south to the west and it was struck to the west. The house was completely destroyed. The minute he was pinned, it became pitch dark and he was unable to see anything for a short while.

When he looked around after it became bright, many blocks of wood were lying heavily on him, but he was able to extricate himself while struggling desperately. When he freed himself, a fire had already started in his neighboring houses. After he rescued his wife, by removing the blocks of wood of the collapsed house, he went to rescue his eldest daughter. As he found daughter's arms sticking out of the remains of the collapsed house, he could rescue her rather easily.

7 SEP 1957
 Radiation Shielding Survey
 Y. MIYAJI

EXAMPLE OF SHIELDING FILE

By that time, the flames approached closer to them and the three of them escaped to the north of the Temma Primary School. As the Temma Primary School building was already swallowed by the flames, they jumped into the Temma River at high tide. From about that time, large drops of rain began to fall heavily. However, the fire did not die out. Sparks of fire shot up and came down violently that it was impossible for them to bear it.

Leaving only his wife and holding on to a drifting wood with his daughter, the two headed to the north and swam as far as the foot of Misasa Bridge where they took a rest. After a short rest, he went down south along the river bank while worrying about his wife. He met his wife in the water under the Hirose Bridge where his wife was waiting for him. The three of them headed toward the north along the river.

They reached their designated place of evacuation at 59-13 Yamate-cho, around 1430 hours via Yokogawa Bridge and Ippon Bridge. On the way, a large number of people suffering from wounds were seen in the rivers and they were avoiding the heat. However, they were dying rapidly one after another.

Since then, they have been residing at 59-13 Yamate-cho. Thus, their designated place of evacuation has turned out to be their present address.

Furthermore, from about 11 August 1945, he commuted to 500 Nishi Temma-cho from Yamate-cho for 10 days in order to clear the fire devastated sites.

Atomic Bomb Casualty Commission
MASTER SAMPLE QUESTIONNAIRE

Project	R.S.S.-1			Family Name (姓)	Given Name (名)	(Kanji)	Master File Number
Previous Contacts							
Project	Remarks	Date of Birth (生年月日)	Sex (性別)	Mar. Stat. (婚姻状況)	Family Name at Birth (出生時ノ姓)	(Kanji)	291-299
		18 Dec. '95	M.	wid.	same		
Present Address (住居地)				Present Occupation (現在の職業)		Industry (産業)	
Yamate-cho 59-13							
Household Head (世帯主)				Relation (本人ノ関係)			
Ind.							
Permanent Address (本居地)				Occupation A.T.B. (原爆時ノ職業)			
Same (at out 50)							
〒天満町 500				東洋其業株式会社			
(1) PRESENT STATUS (現在)							
Living within City (市内居住)	<input checked="" type="checkbox"/>	Survival (生存ノ否)	Date of Death (死亡年月日)		Locality of Death (死亡場所)		Cause of Death (死亡原因)
Moved out of City (市内移居)	<input type="checkbox"/>	存					
Unable to locate (不明)	<input type="checkbox"/>	Remarks (其ノ他ノ記事)					
Deceased (死亡)	<input type="checkbox"/>						
(2) EXPOSURE DATA (被曝状況)							
Under 250m (以下)	<input checked="" type="checkbox"/>	Over 250m (以上)	<input type="checkbox"/>	Res. Stat. (居住状況)	<input type="checkbox"/>	Not Exp. (不明)	<input type="checkbox"/>
Exact Location at time of Bomb (原爆時ノ正確ノ位置)				Coordinates (座標)		Distance from Epicenter (爆心ヨリノ距離)	
Nishi-Temma-cho 500				22.56 x 12.23		1.35517	
Summary of Shielding (遮蔽ノ概要)				Shielding			
Single story Japanese type house				6			
Reason of Location A.T.B. (原爆時ノ立地ノ理由)				Was person caught in Fallout Data? (原爆時ノ降下物ニ捕らレタカ)		Where? (場所)	
存 在 否				Yes <input checked="" type="checkbox"/> No <input type="checkbox"/> Unk. <input type="checkbox"/>		天満町	
Date of entry to City and approx. time within City (入都年月日及市内ノ概シクノ時間)		Date of Entry (入都年月日)		Period (期間)		Area (区域)	
(3) OTHER PEOPLE WITH SUBJECT PERSON A.T.B. (同被曝者ノ他ノ人々)							
M.F. Number	Name (姓名)	Sex (性別)	Date of Birth (生年月日)	Address (住居)		Survival (生存ノ否)	
292-000		F.	22 Aug '97	Yamate-cho 59-13		生存	
292-001		F.	12 Oct '20			生	
(4) RESIDENTIAL HISTORY (住居ノ履歴) (Commence from present address) (現在ノ住居ヨリ)							
Address (住居)		Beginning (開始)		Ending (終了)		Reason for Move (移動ノ理由)	
Yamate-cho 59-13		21 Aug '95		pres.		原爆ノ後	
Nishi-Temma-cho 500		'24 of Aug. '95				東照ノ都合上	
Temma Hon-machi 92		'69		'94		就職ノ為	
Yamagata-gun Togachi-cho		p.o.a.		'69			
Residence Abroad (海外ノ居住)		Length of Residence Abroad (海外居住ノ期間)		Reason for Residence Abroad (海外居住ノ理由)			
None		None		None			
Place of Birth (出生地) 新潟県小浜郡中津川町		Origin (出生地) 中津川市		Length of Residence at Origin (出生地ニ於テノ居住ノ期間) 91年			
(5) FAMILY MEMBERS (Only exposed members) (被曝者ノ家族)							
M.F. Number	Name (姓名)	Sex (性別)	Date of Birth (生年月日)	Relation (関係)	Exposure Data and Remarks (被曝状況及備考)		
292-001		F.	12 Oct '20	長女	Nishi-Temma-cho 500. Good health.		

M.F.D. 127211.

AEC Form No. STAT-18-B-1 (May 1961)
MASTER SAMPLE QUESTIONNAIRE

EXAMPLE OF SHIELDING FILE

RADIATION SYMPTOMS HISTORY (症状履歴)							
(6) INJURIES (外傷)				(7) FLASH BURNS (閃光傷)		(8) FIRE BURNS (火傷)	
Wounds (創傷) <input checked="" type="checkbox"/>	Bruises (挫傷) <input type="checkbox"/>	Glass Cuts (硝子破片傷) <input checked="" type="checkbox"/>	Broken Bones (骨折) <input type="checkbox"/>	Other (其/他) <input checked="" type="checkbox"/>	Scars (傷痕) <input type="checkbox"/>	keloid (ケロイド) <input type="checkbox"/>	Scars (傷痕) <input type="checkbox"/>
Describe Injuries and Healing (外傷及び治癒/状態ヲ記述)				Describe Extent, W-res, Healing etc. (範囲・程度・治癒/状態ヲ記述)		Describe Extent, Degree, Healing etc. (範囲・程度・治癒/状態ヲ記述)	
石原君は硝子破片傷を全身に受けた。25年7月2日				None		None	
破片傷。全身に全治15年7月2日							
(9) SYMPTOMS (症状)							
Type of Symptom (症状ノ種類)	Date of Onset (発症日)	Mild (軽度)	Moderate (中等度)	Severe (重度)	Unk. (不明)	None (無)	Duration or Comment (継続期間及備考)
Fever (発熱)						<input checked="" type="checkbox"/>	
Malaise (全身倦怠)						<input checked="" type="checkbox"/>	
Vomiting (嘔吐)						<input checked="" type="checkbox"/>	
Nausea (嘔心)						<input checked="" type="checkbox"/>	
Anorexia (食欲不振)						<input checked="" type="checkbox"/>	
Diarrhea (non-bloody) (下痢・血性)	11 Aug '55	<input checked="" type="checkbox"/>					3月14日 = 27/10 = 2~3回
Diarrhea (bloody) (下痢・血性)	11 Aug '55	<input checked="" type="checkbox"/>					2月14日 = 27/10 = 2~3回
Sore Throat (咽頭痛)						<input checked="" type="checkbox"/>	
Sore Mouth (口内瘡)						<input checked="" type="checkbox"/>	
Sore Gums (歯肉痛)						<input checked="" type="checkbox"/>	
Bleeding Gums (出血性歯肉)	11 Aug '55	<input checked="" type="checkbox"/>					2月14日 = 27/10 = 少量
Peppurs (膿点出血)						<input checked="" type="checkbox"/>	
Other Bleeding (其/他ノ出血)						<input checked="" type="checkbox"/>	
Erythema (発疹)						<input checked="" type="checkbox"/>	
(10) MENSES (月経)							
Did Patient have Amenorrhea (無月経ノ有無)		Length of Time Experienced (持続期間)		Cause of Amenorrhea (if known) e.g. pregnancy, lactating, etc. (令レノ原因ヲ詳述シテ月経ノ停止ノ原因ヲ記述)			
Yes <input type="checkbox"/> No <input type="checkbox"/> Unk. <input type="checkbox"/>							
General Statement Concerning Present Health (現在ノ健康)						Map of Address (住所地図)	
Good Health							
Additional Information (其/他ノ記事)							
Source of Information (情報ノ来源)		Relationship (本人ノ関係)		Address (住所)			
Individual				Yamate-cho 59-13			
Reliability (信頼度)		Name of Investigator (調査員氏名)		Date of Investigation (調査日)			
Good		Y. MIYAJI		SEP 07 1957			

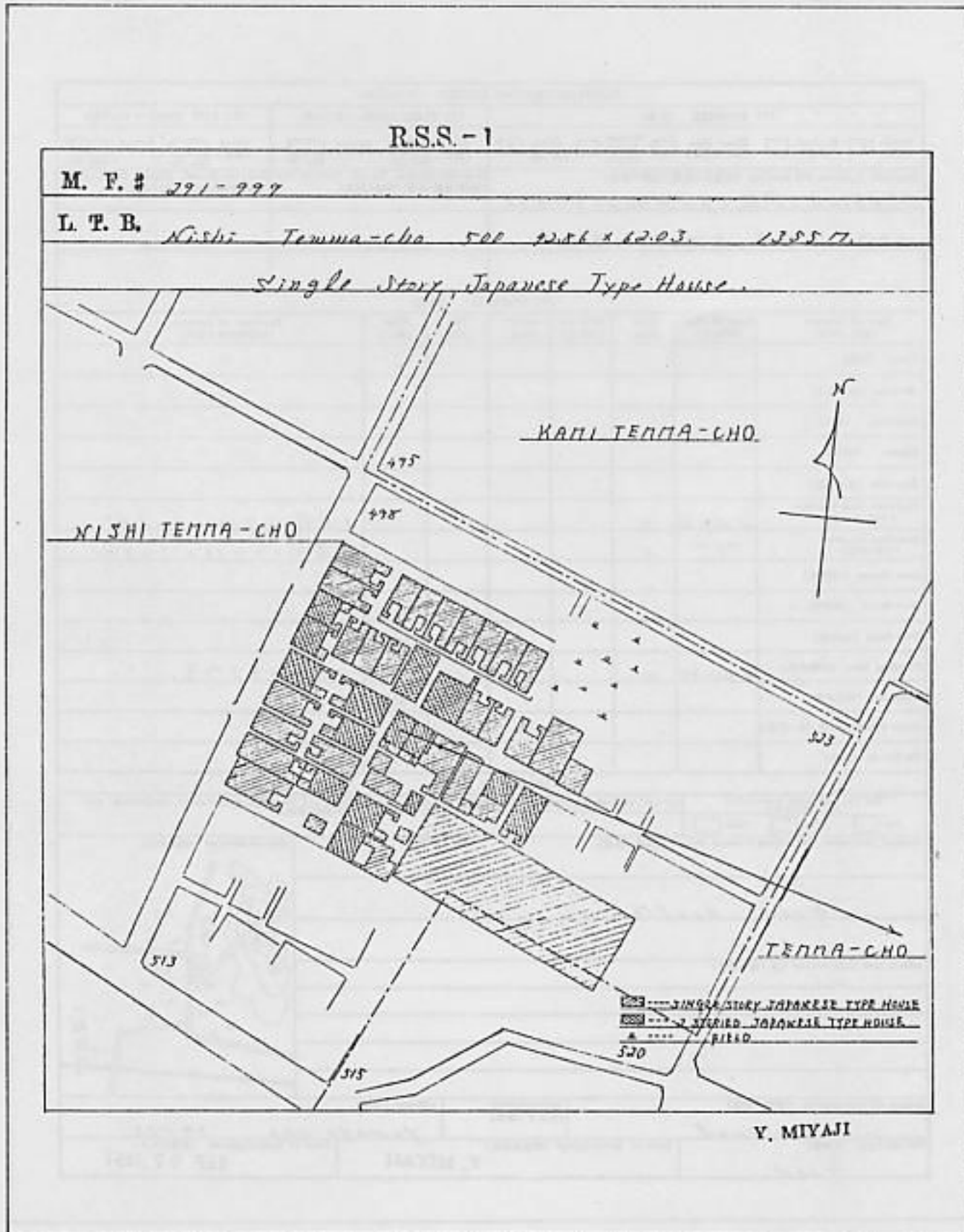

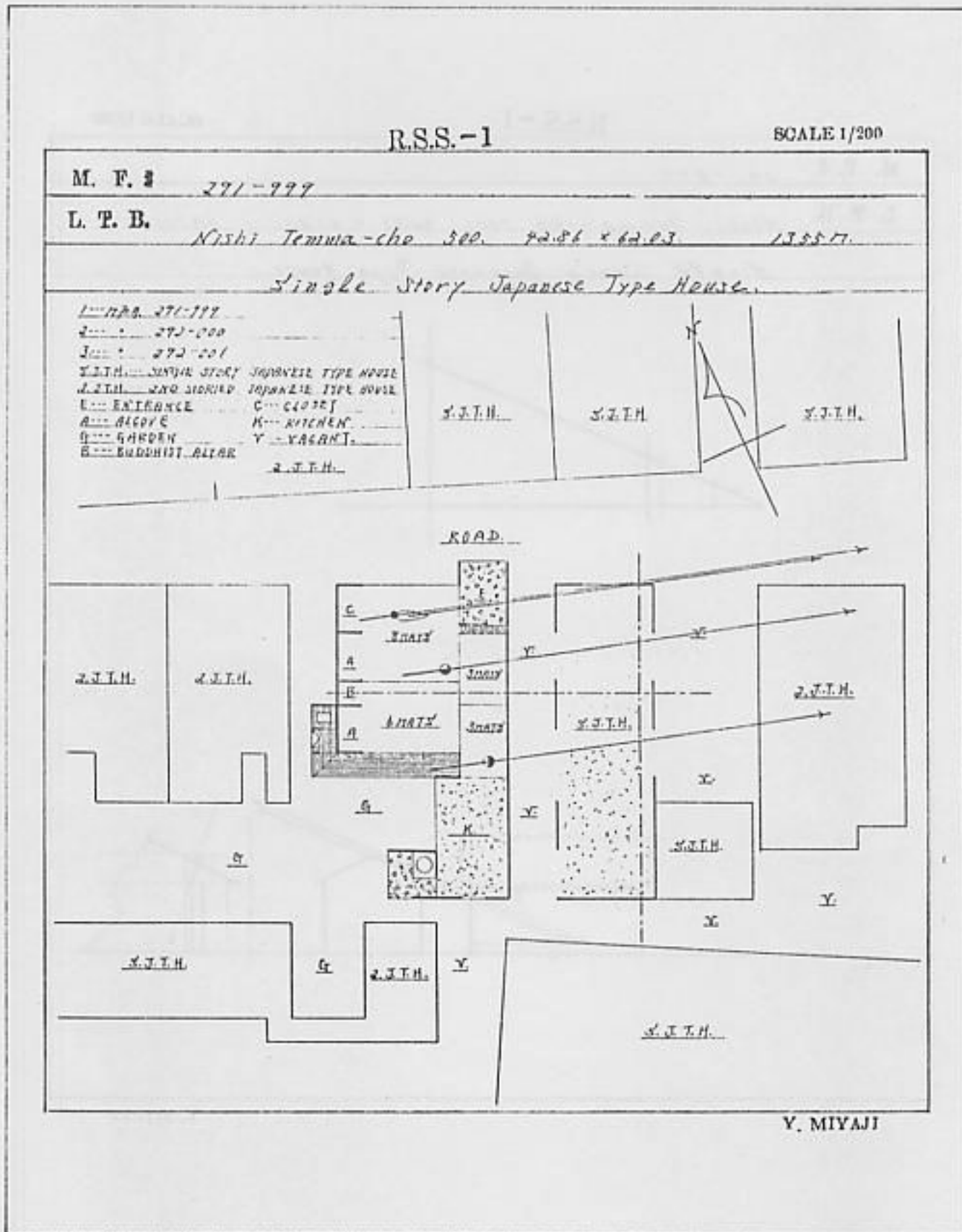

R.S.S.-1

SCALE 1/200

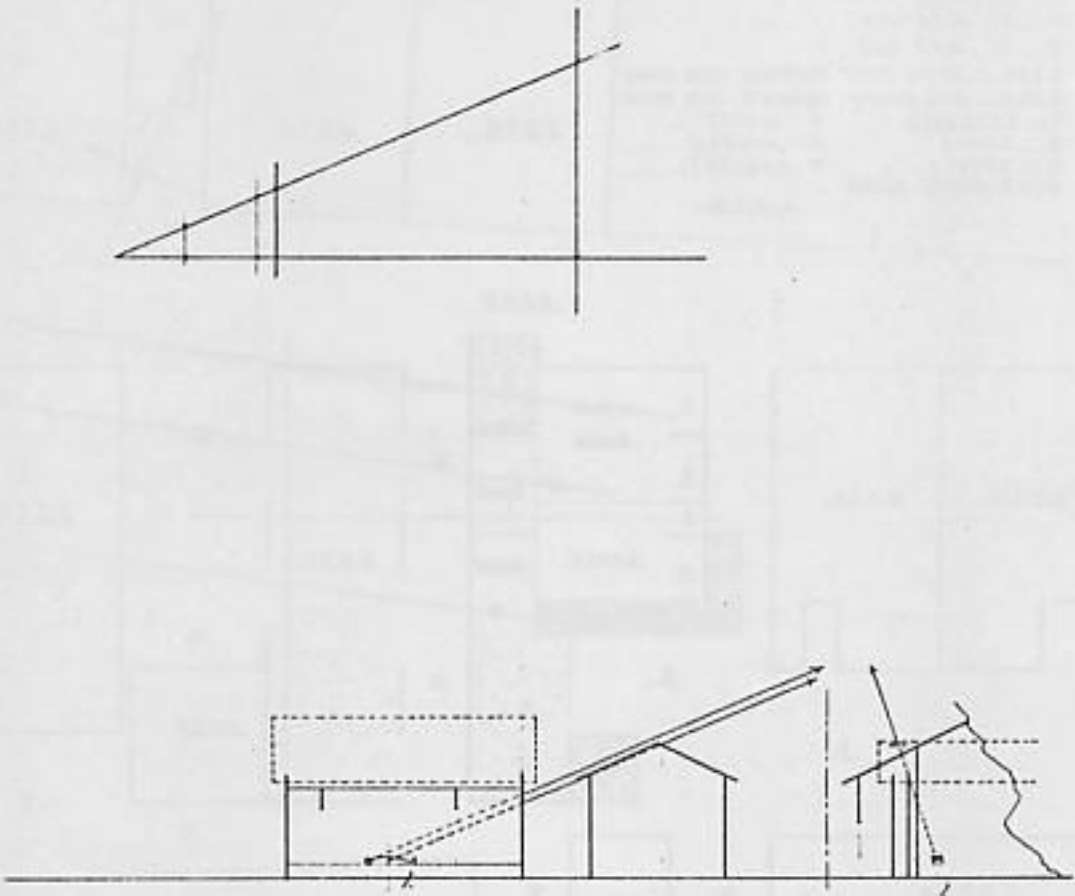
M. F. #	271-999
L. P. B.	Nishi Tamma-cho 500 42.86 x 62.03 135577.
Single Story Japanese Type House.	
	

Y. MIYAJI

EXAMPLE OF SHIELDING FILE

Date coded: MAR 26, 1965

CODE SHEET FOR SHIELDING PARAMETERS

MF Number: 2 9 1 9 9 9
 Sex: /
 City Exp.: /
 Coordinates: 4 2 8 6 * 6 2 0 3 *1355m*

F.S.: 5
 F.S.S.: /
 U.S.: 1 0 0
 L.S.: 2
 I.F.W.: 0
 I.L.W.: 0
 H.F.: 0 /
 F.N.: /
 S.P.: 0 4 4 9

Certainty of Coding:
 F.S.: /
 F.S.S.: /
 U.S.: /
 L.S.: /
 I.F.W.: /
 I.L.W.: /
 H.F.: /
 F.N.: /
 S.P.: /

Comp. Shi.: /
 Attenuation factor:
 Gamma: 0 6 2
 Neutron: 0 4 1
 Desc. House: /
 Treat. House: 2
 Treat. Project a. b.: / /

Elev.: /
 Grove: /
 Pres. Disp.: /

	Gamma	Neutron	Remarks
Air Dose			
Attenuation Factor			
Dose			

Notes:

CORRECTED

CODED

PUNCHED

Date of Form: 1 Oct. '64
 Stat. Dept.